

Mini-level float switches

Description **MSN1-MS-R1/8-S 0043**

Article number **6891271003**

Performance diagram
(maximum data)

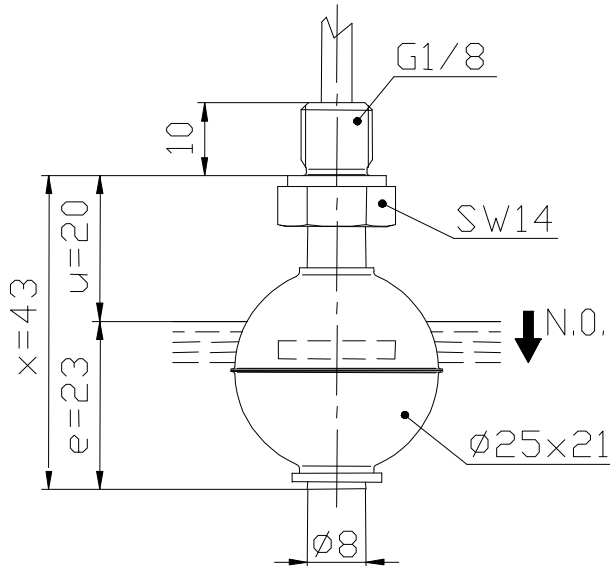
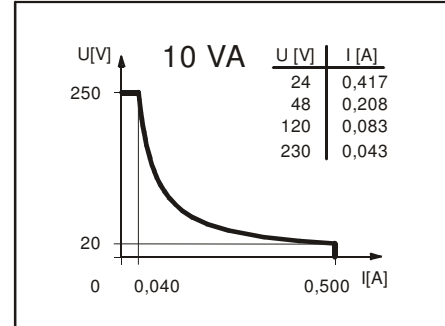

Wiring diagram
(without liquid)

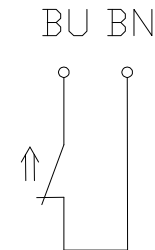

Electrical data

Reed contact	max. switching voltage	250 V
	max. switching current	0,5 A
	max. switching capacity	10 VA
	mechanical life	10 ⁷ to 10 ⁹ switches depending on the load
Switching element		1 normally open contact, falling level
Direction category		AC-21A and DC-21A acc. to DIN VDE 0660 T107
Standard		acc. to DIN VDE 0660 T200

Mechanical data

Screw connection material	CuZn39Pb3 (2.0401)
Switching tube material	CuZn37 (2.0321)
Float material	PP
-density	about 0,65 g/cm ³ ±10%
-depth of immersion	18 mm ±2 mm (to a fluid-density of 1 g/cm ³)
Grip screw material	CuSn8 (2.1030)
Ambient air temperature	-5°C to +60°C
Liquid temperature	-5°C to +60°C
Connection	1m cable, PVC, 2x0,34mm ²
Protection type	IP 65 acc. to DIN VDE 0470 T1
Max. pressure	5 bar

General details

Repeatability of switching points is ±0,05mm based on the same geometrical conditions as of a switch device.
 The measures of the switching points refer to a fluid-density of 1 g/cm³.
 The tolerance of the switching points is ±2mm
 Pay attention to the contact protection, when switching inductive loads. Maximum data must not be exceeded!

Subject to change without notice.

Date of issue : 11.10.2007 / Page 1 of 1
 Document : 6891271003_en.doc / Last update : 1