

Mini-level float switches

Description **MSN1-NI-R3/8-U 0045**

Article number **6891173025**

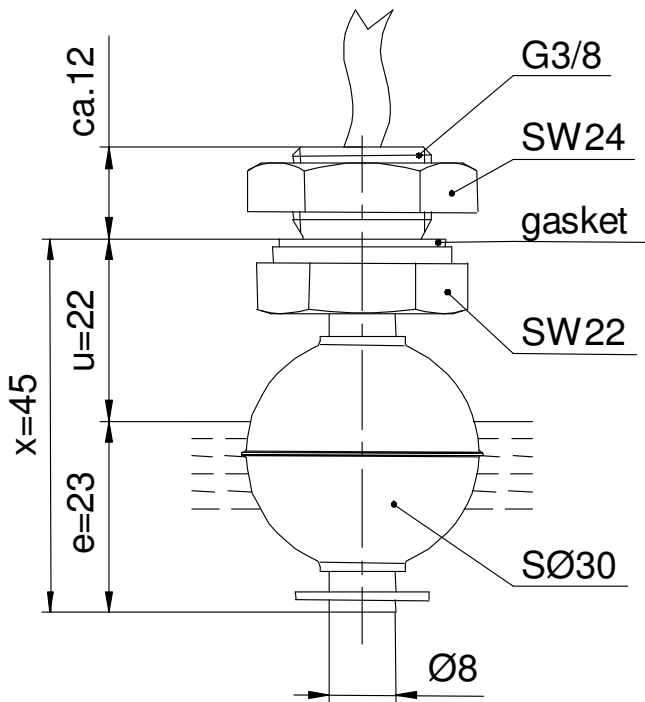

Performance diagram
(maximum data)

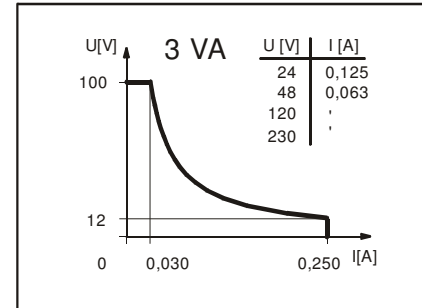

Wiring diagramm
(matching to the drawing)

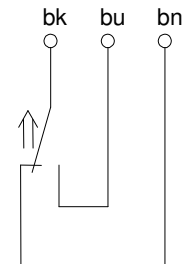

Electrical data

Reed contact	max. switching voltage	100V
	max. switching current	0,3A
	max. switching capacity	3VA
	mechanical life	10 ⁷ to 10 ⁹ switches depending on the load
Switching element		1 change-over contact, falling level
Direction category		AC-21A and DC-21A acc to DIN VDE 0660 T107
Standard		acc to DIN VDE 0660 T200

Mechanical data

Hexagon nut material	1.4305 (stainless steel)
Screw connection material	1.4571(stainless steel)
Switching tube material	1.4571(stainless steel)
Float material	1.4571(stainless steel)
-density	about 0,65 g/cm ³ ±10%
-depth of immersion	18 mm ±2 mm (to a fluid-density of 1 g/cm ³)
Adjusting ring material	1.4571(stainless steel)
Gasket material	NBR
Ambiente air temperature	-5 °C bis -60 °C
Medium temperature	-5 °C bis -60 °C
Connection	2m cable, PVC, 3x0,34mm ²
Protection type	IP 65 acc to DIN VDE 0470 T1
Max. pressure	10 bar

General details

Reproducibility of switching points is ±0,05mm based on the same geometrical conditions as of a switch device.
The measures of the switching points refer to a fluid-tight of 1 g/cm³.
The tolerance of the switching points is ±2mm
Pay attention to the contact protection, when switching inductive loads. Maximum data must not be exceeded!

Subject to change without notice.

Date of issue : 26.08.2005 / Page 1 of 1
Document : 6891173025_en.doc / Last update : 1