

Capacitive Proximity Switch

Series M18

Description **KCN-T18PS/013-KLP3**

Article number **6607921461**

Wiring Diagram

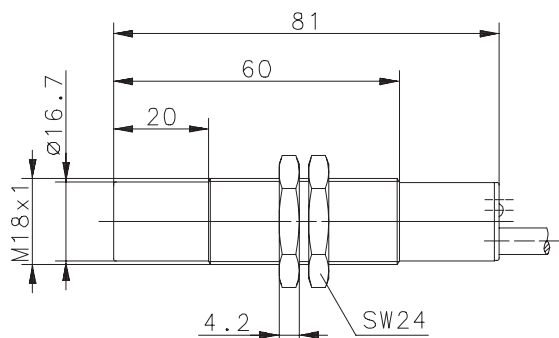
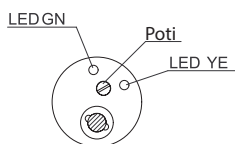
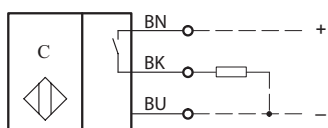

Identifying characteristics in accordance with EN 60947-5-2

Electrical data		
Rated operating distance	S_n	13,5 mm
Mounting		non flush
Standard target		50 mm x 50 mm x 1 mm; material: steel; connected to earth
Effective operating distance	S_r	13-14 mm; S_r adjustable with potentiometer (Poti); turn right \triangle high sensitivity, turn left \triangle low sensitivity
Assured operating distance	S_a	$0 \leq S_a \leq 0,8 \cdot S_r$
Switching element function		N.O., Relay, change over contact with induction protection
Repeat accuracy	R	$\leq 0,1 \cdot S_r$
Differential travel (hysteresis)	H	$\leq 0,2 \cdot S_r$
Rate operational voltage	U_e	12-48 V DC
Operational voltage range	U_B	10 V ... 60 V DC
Rated insulation voltage	U_i	75 V AC
Rated impulse withstand voltage	U_{imp}	500 V
Protection class		II, totally insulated
Rated current	I_e	200 mA DC
Minimum operational current	I_m	≥ 1 mA DC
Off-state current	I_r	$\leq 0,5$ mA DC
No-load supply current	I_o	≤ 20 mA
Switching element		permanent overload and s.c.p.
Short-circuit protection		pulsed
False polarity protection		yes
Rated supply frequency		DC
Relay drop-out delay	t	$\approx 1 - 600$ s \Rightarrow adjustable with potentiometer (Poti Timer); turn right = long delay, turn left = short delay
Frequency of operating cycles	f	≈ 25 Hz
Time delay before availability	t_v	≤ 50 ms

BERNSTEIN AG · Hans-Bernstein-Straße 1 · 32457 Porta Westfalica · www.bernstein.eu

Technical modifications and errors excepted.

The technical datasheet corresponds to the technical state as of 2020-03-09 and will not be removed in case of changes.

Mechanical Data	
Enclosure	PBT, black
End cap	PA 6.6, black
Temperature range	- 5 °C ... + 70 °C (cable not fixed mounted) - 25 °C ... + 70 °C (cable fixed mounted)
Type of protection	IP65
Pollution degree	3 (Pollution of the active zone can cause impairments of the operating distances.)
Indication	Power ON = LED green Output ON = LED yellow
Termination type	Cable 3 x 0,5 mm ² x 3 m, PVC-outer jacket black
For attachment	2 x Hexagon nut, PA6.6, black

EU Conformity
acc. to directive 2014/30/EU (EMC-Directive)

Notes
Customer-specific