

## Inductive Proximity Switch Series M18

Description **KIN-M18PA/008-S12**

Article number **6602006111**

### Wiring Diagram

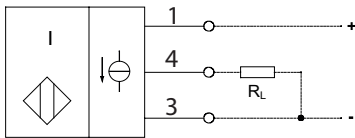

### Characteristic

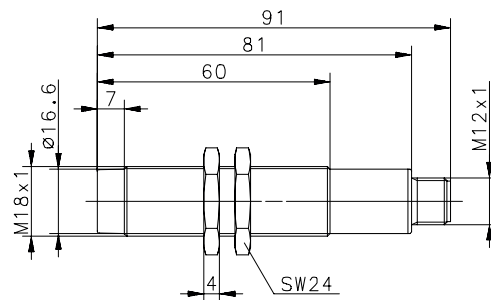
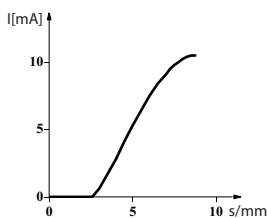

### Electrical data

Range of measurement	S	3-8 mm
Mounting		non flush
Power output		0-10 mA
Repeat accuracy		≤ 2 % referring to the accumulated value (10 mA)
Linearity error		± 5 % referring to the accumulated value (10 mA)
Temperature error		± 15 % referring to the accumulated value (10 mA)
Rated operational voltage	$U_e$	12-24 V
Operational voltage range	$U_B$	10-36 V; incl. ripple frequency
No-load supply current	$I_o$	20 mA
False polarity protection		protection against reverse supply polarity
Switching element		permanent overload and s.c.p.
Transient voltage rate		500 V for 1 ms at $R_i=500 \Omega$

### Mechanical Data

Enclosure	M18 x 1, brass nickel plated
Ambient air temperature	-25 °C ... +70 °C
Type of protection	IP67 (with connected socket)
Termination type	Plug connection
Vibration	10-55 Hz; a=1 mm
Shock	30 g; $t_{shock}=11 \text{ ms}$

### EU Conformity

acc. to directive 2014/30/EU (EMC-Directive)