

Magnetic Switch Series MA-44

Description **MAK-4413-D-1**

Article number **6317344719**

Wiring diagram

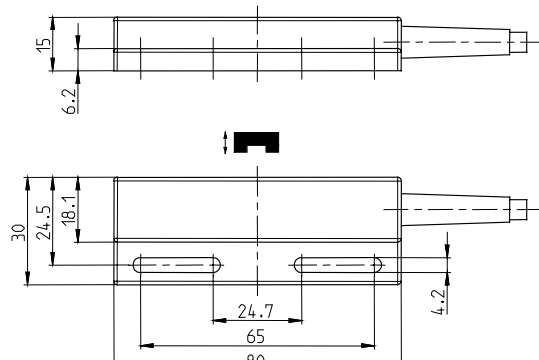
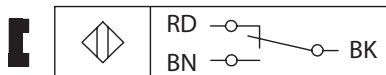

Technical data

Switching function	C.O.
Reference magnet	T-44 (6302144071)
Assured operating distance - ON	S_{ao} 22 mm
Assured operating distance - OFF	S_{ar} 44 mm
Repeat accuracy	R $\pm 0,1$ mm, under same geometrical conditions at the same temperature
Utilization category	DC-12

Electrical data

max. switching voltage	125 V AC / 175 V DC
max. switching current	280 mA AC / 400 mA DC
max. switching capacity	5 VA
Protection class according to EN IEC 61558	III (Safety Extra Low Voltage)
Note	Combinations of switching voltage and switching current must not exceed the maximum switching capacity.

Mechanical data

Enclosure	PA6.6, black; encapsulated reed contact
Temperature range	- 10 °C to + 80 °C (cable moved) - 30 °C to + 105 °C (cable fixed)
Mechanical lifetime	3×10^8 switchings
Type of protection	IP 67 acc. to EN 60529
Termination type	cable 3 x AWG 20 x 1 m ± 5 %; PVC -outer jacket black;
Assembly position	optional (assembly on iron means reduction of switch distance)

Standards

EN 62246-1
EN 60947-5-1

EU Conformity
acc. to directive 2011/65/EU (RoHS-directive)

Approvals	
	UL Listed, Ind. Cont. Eq. / Class 2 Power source
	Note limited electrical data:
	max. switching voltage 30 V AC / 60 V DC
	max. switching current 0,25 A
	max. switching capacity 5 VA

Notes
Contact protection must be provided for inductive and capacitive loads.