

Technical Data

Magnetic switch

Series MA-08

Type designation **MAN-0812-B-2**

Item number **6311208614**

Wiring diagram

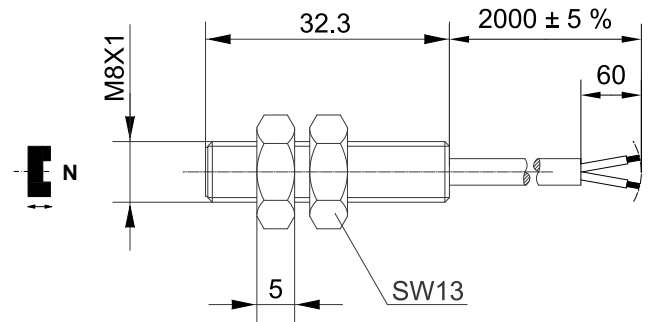
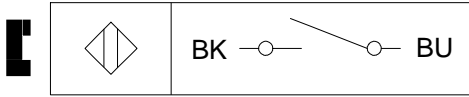

Identifying characteristics in accordance with EN 60947-5-1 and EN 62246-1

Electrical data

Assured operating distance	S _a	18mm
Switching element function		N.O.
Reed contact:		
max. switching voltage		250V
max. switching current		0,5A
max. switching capacity		10VA
mechanical lifetime		3x10 ⁸ switchings, however, according to load resetability
Repeat accuracy	R	± 0,1mm
Release point		under same geometrical conditions at the same temperature
Shock		42mm
Vibration		50 g (11ms, ½ sine wave)
Corresponding magnet		35g (10-1000 Hz)
		T-62 N/S

Mechanical data

Enclosure	Stainless steel (Niro 1.4305); encapsulated reed contact
Ambient air temperature	-20° C ... +70° C (cable fixed mounted)
Type of protection	IP67 (NEMA 4) according to IEC 529, EN 60529
Termination type	cable 2 x 0,14mm ² , PVC -outer jacket black
Assembly position	optional (assembly on iron means reduction of switch distance)
Fixing accessories	2 x hexagon nut (PA, black)

EU Conformity

acc. to Directive 2006 / 95 / EC

This document will not become the contractual basis; the details included herein do not constitute any descriptions of expected conditions, so that warranties/claims for defects on account of possible variations of the actual from the here described condition are excluded. Subject to modifications and amendments.

Date of issue: 31.10.2012 / Page 1 of 1
Document: 6311208614_en.doc / Last update: 1 / 0402-12