

## Metal bodied limit switch

### Series GC

Description **GC-SU2 RIW 90GR M12**

Article number **6122267971**

#### Operating symbol

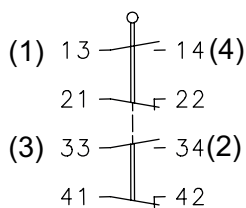

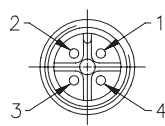

#### Connector

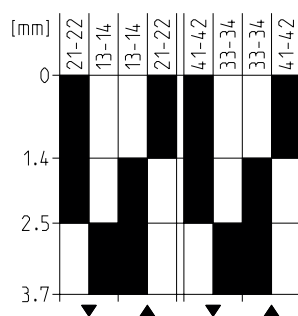

#### Operating diagram



 On  
 Off

Tolerance:  
 Operating point  $\pm 0,25$  mm;  
 Operating force  $\pm 10$  %

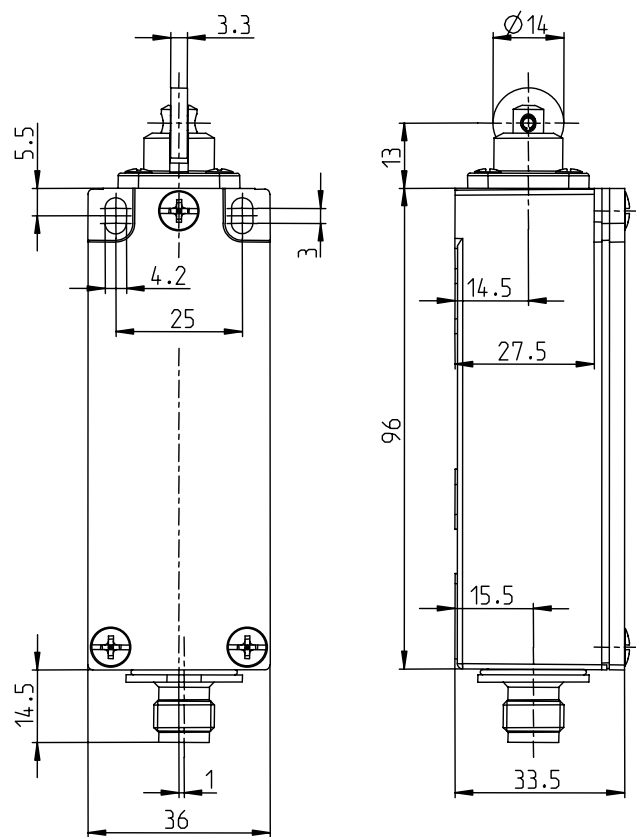

#### Electrical Data

|                                 |                                |      |
|---------------------------------|--------------------------------|------|
| Rated operational voltage       | $U_e$                          | 24 V |
| Utilization category            | AC-15, $U_e/I_e$ 24 V / 1,5 A  |      |
| Short-circuit protective device | Fuse 2 A gG                    |      |
| Protection class                | III (safety extra-low voltage) |      |

| Mechanical data         |                                      |
|-------------------------|--------------------------------------|
| Enclosure               | Die-cast aluminium                   |
| Cover                   | Sheet aluminium                      |
| Actuator                | Roller (steel)                       |
| Ambient air temperature | -30 °C ... +80 °C                    |
| Contact type            | 2 N.C., 2 N.O.                       |
| Mechanical life         | 3 x 10 <sup>6</sup> operating cycles |
| Switching frequency     | ≤ 100 / min.                         |
| Assembly                | 2 x M4                               |
| Connection              | Connector M12x1; A coded             |
| Weight                  | ≈ 0,22 kg                            |
| Installation position   | operator definable                   |
| Protection type         | IP65 acc. to IEC/EN 60529            |

| Actuation  |
|--|
| By loosening the 4 screws the actuation assembly can be rotated in 90 degree increments such that 4 actuation directions are possible. The actuation assembly is to be again fastened to the housing using the 4 screws. |

| Standards        |
|------------------|
| DIN EN 60947-5-1 |

| Notes  |
|--|
| <p>The degree of protection specified (IP code) applies only to a properly closed cover and the use of an equivalent connector. The connector and the cable (fix or flexible mounted) must at least be suitable for the described ambient air temperatures. The connector must not be connected or disconnected when voltage is applied.</p> <p>The mechanical life of the connector is 500 connection cycles.</p> <p>Suitable connector and cable must be used to meet approval requirements.</p> |