

Technical Data

Magnetic switch

Series MAK

Type designation **MAK-0213-L-10**

Item number **6416302608**

Wiring diagram

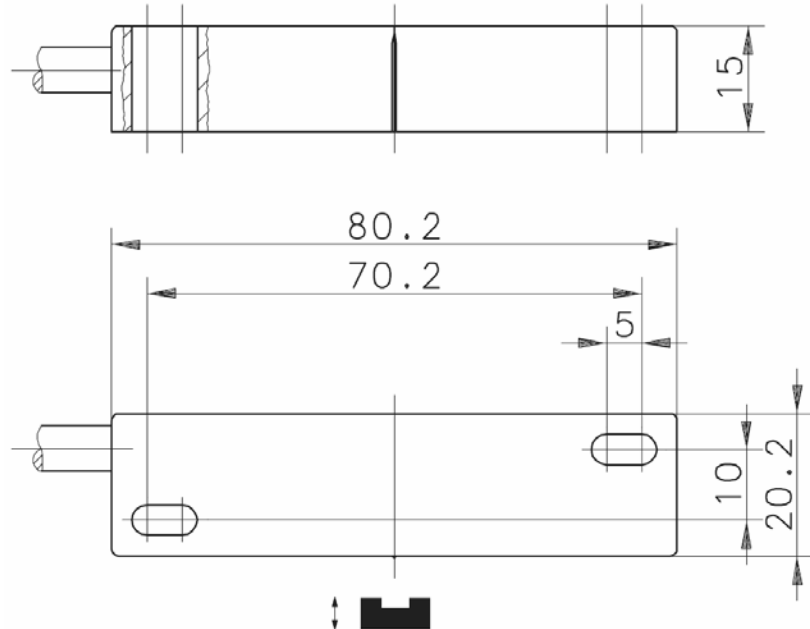
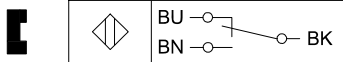

Identifying characteristics in accordance with EN 60947-5-1 and EN 62246-1

Electrical data

Assured operating distance	S_a	24 mm
Switching element function		Switch-Over
Reed contact:		250 V
max. switching voltage		1,0 A
max. switching current		60 VA
max. switching capacity		3 VA
min. switching capacity		3×10^8 switchings, however, according to load resetability
mechanical lifetime		$\pm 0,1$ mm
Repeat accuracy	R	under same geometrical conditions at the same temperature
Release point		45 mm
Shock		10 g (11ms, $\frac{1}{2}$ sinus-wave)
Vibration		15 g (50-2000Hz)
Corresponding magnet		T-21-02

Mechanical data

Enclosure	PA6.6, Schwarz; encapsulated reed contact
Ambient air temperature	-5° C ... +70° C
Type of protection	IP67 (NEMA 4) according to IEC 529, EN 60529
Termination type	cable 3 x 0,75 mm ² x 10 m; PVC-outer jacket black
Assembly position	optional (assembly on iron means reduction of switch distance)

EU Conformity

acc. to directive 2006 / 95 / EC

This document will not become the contractual basis; the details included herein do not constitute any descriptions of expected conditions, so that warranties/claims for defects on account of possible variations of the actual from the here described condition are excluded. Subject to modifications and amendments.

Date of issue: 22.04.2013 / Page 1 of 1
Document: 6416302608_en / Last update: 1 / 0490-09