

Magnetic switch

Series MA-30

Description **MAK-3012-B-5,5**

Article number **6311230646**

Wiring diagramm

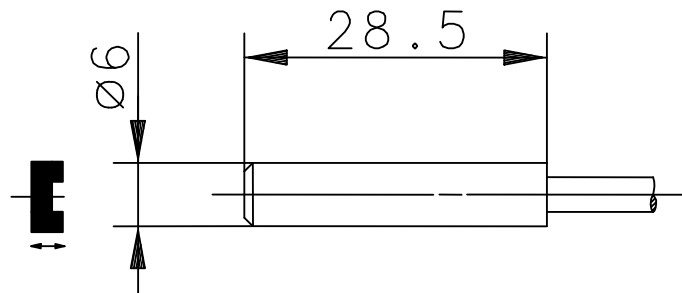
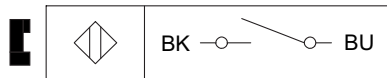

Identifying characteristics in accordance with EN 60947-5-1 and EN 62246-1

Electrical data	
Contact closed	≤ 19 mm
Switching element function	Make function
Max. switching voltage	250 V
Max. switching current	0,5 A
Max. switching capacity	10 VA
Mechanical lifetime	3×10^8 switchings, however, according to load resetability
Repeat accuracy	R $\pm 0,1$ mm under same geometrical conditions at the same temperature
Contact opened	≤ 32 mm
Shock	100 g (11 ms / $\frac{1}{2}$ Sinewave)
Vibration	30g (50 - 2000 Hz)
Corresponding magnet	T-62 N/S

Mechanical data	
Enclosure	PA 6.6; encapsulated reed contact
Ambient air temperature	$-5^\circ\text{C} \dots +70^\circ\text{C}$
Type of protection	IP67 acc. ICE 529, EN 60529
Termination type	cable $2 \times 0,14 \text{ mm}^2 \times 5,5 \text{ m} \pm 5\%$; PVC -outer jacket black
Assembly position	optional (assembly on iron means reduction of switch distance)

EU Conformity	
acc. to directive 2006/95/EC	