

Technical Data

Magnetic switch

Series MA-81

Type **MAK-8112-2**

Ident.-No. **6310281656**

Wiring diagram

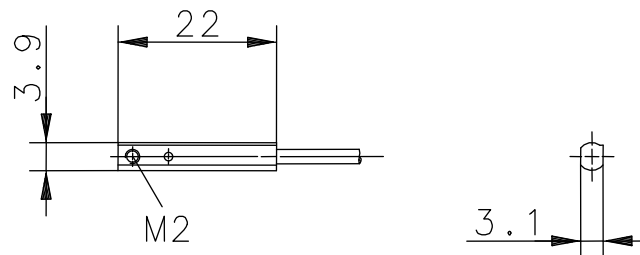
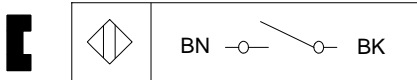

Electrical data

Contact	15-20 AW
Switching element function	Make function
Reed contact:	120 V AC / 170 V DC
max. switching voltage	0,5 A
max. switching current	10 VA
max. switching capacity	10 ⁸ switchings, however, according to load resetability
mechanical lifetime	100 g, 11 ms, ½ sine wave
Shock	10 ... 2000 Hz
Vibration	customer specific
Corresponding magnet	

Mechanical data

Enclosure	PA, black; encapsulated reed contact
Ambient air temperature	-5° C ... +70° C
Type of protection	IP67 (NEMA 4) according to IEC 529, EN 60529
Termination type	Cabel 3 x 0,05 x 2 m, PUR-Outer jacket, black (wire BU separated)
Assembly position	optional (assembly on iron means reduction of switch distance)

This document will not become the contractual basis; the details included herein do not constitute any descriptions of expected conditions, so that warranties/claims for defects on account of possible variations of the actual from the here described condition are excluded. Subject to modifications and amendments.

Date of issue: 05.09.2012 / Page 1 of 1
Document: 6310281656_en / Last update: 1 / 0324-12