

Foot-switch Series F2

Description **F2-SU1ZAT/SU1ZAT UN**

Article number **6162830834**

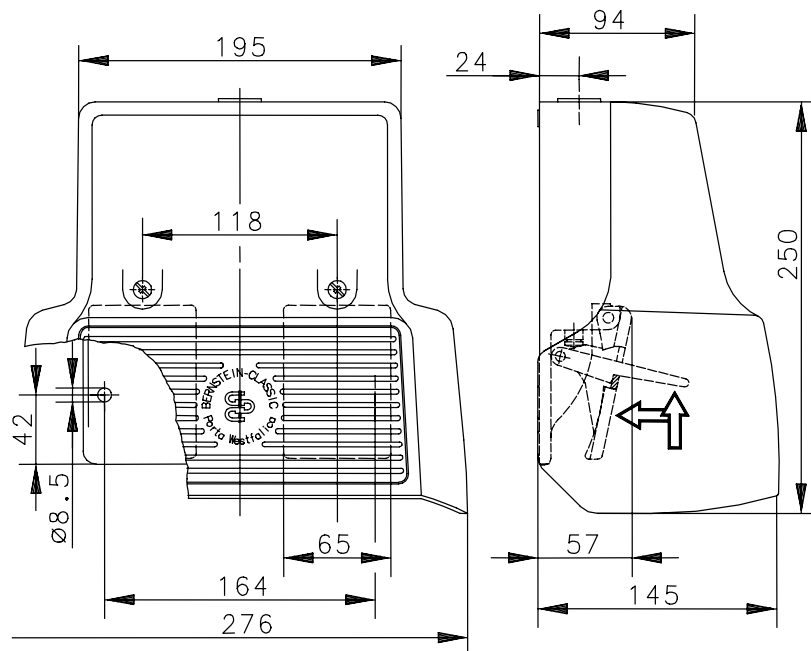

Switching symbol

Pedal left

Pedal right

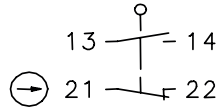
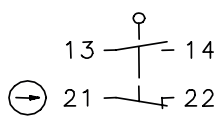

Electrical data

| | | |
|---------------------------------|-----------|------------------------------------|
| Rated insulation voltage | U_i | 400 V AC |
| Conv. thermal current | I_{the} | 10 A |
| Rated operational voltage | U_e | 240 V |
| Utilization category | | AC-15, U_e/I_e 240 V / I_e 3 A |
| Direct opening action | \ominus | acc. to IEC/EN 60947-5-1, Annex K |
| Short-circuit protective device | | Fuse 2 A gG |
| Protection class | | I |

| Mechanical Data | |
|--|---|
| Enclosure | AL, die-cast |
| Protective guard (Accident protection cover UN) | AL, die-cast, colour: Golden yellow (RAL 1004) |
| Actuator | Foot lever (PA) |
| Ambient air temperature | -30 °C ... +80 °C |
| Contact type | 2 N.C. / 2 N.O. (Zb) |
| Operating force | ≈ 10 N (pedal centre) |
| Mechanical life | 10 x 10 ⁶ switching cycles |
| Switching frequency | ≤ 50/min |
| Assembly | 2 x M8 |
| Connection | screw terminals (M3,5) |
| Number of connections | 8 |
| Protection ground | 2 x M4 |
| Conductor cross-sections | Solid: 0,5 – 1,5 mm ² Litz wire with or without ferrules: 0,5 – 1,5 mm ² |
| Cable entry size | 1 x M20 x 1,5 |
| Weight | ≈ 2,6 kg |
| Protection type | IP 65 acc. to IEC/EN 60529 |

| ID for safety engineering | |
|----------------------------------|---------------------------------------|
| B10d | 20 x 10 ⁶ switching cycles |

| Standards | |
|------------------|------------------|
| | DIN EN 60947-5-1 |

| EU Conformity | |
|----------------------|--|
| | acc. to directive 2014/35/EU (Low-Voltage-Directive) |

| Notes | |
|---|--|
| The degree of protection specified (IP code) applies only to a properly closed protective guard and the use of an equivalent cable gland with adequate cable. | |